

# SOPREMAPOOL

Waterproofing solutions for **public, sports and recreational pools**

Waterproofing



# Contents

SOPREMA presentation	03
Reinforced membranes: The preferred choice for pool waterproofing	04
<b>SOPREMAPOOL ranges</b>	<b>09</b>
SOPREMAPOOL	10
Ranges	11
SOPREMAPOOL Feeling Plus	12
SOPREMAPOOL Premium	13
SOPREMAPOOL Design	14
SOPREMAPOOL 3D	15
<b>International projects</b>	<b>17</b>
Technical expertise at your service	28
Technical resources that support every project	30



# SOPREMA presentation

SOPREMA, a family-owned company since 1908, has consolidated itself in recent years as one of the leading companies in the world in the fields of waterproofing, thermal insulation, acoustics, and coatings.

The development of our construction solutions is the result of close collaboration between our clients, sales, specification, and technical departments, as well as our research and development centers. Our product offering is innovative and perfectly aligned with market demands and current standards. SOPREMA's products and services aim to meet the most demanding needs of construction professionals, whether for roof waterproofing, reinforced synthetic membranes for pool waterproofing, civil engineering, thermal and acoustic insulation, or photovoltaic and green roofing. At SOPREMA, we work daily with our clients to find the right solution for every type of need. SOPREMA stands for strength and solidity, a track record of success, and worldwide recognition for the quality of our reliable, durable, and efficient products and systems.

At SOPREMA we are deeply committed to sustainability and work towards a sustainable construction model focused on two main points: the manufacture of energy-efficient products and the adoption of a closed, circular life-cycle construction model that allows for the reuse of construction waste. It is essential to promote a renewed vision of construction with more responsible and environmentally friendly practices.

 **+5** BILLION EUROS  
OF TURNOVER

 **+120**  
SUBSIDIARIES

**48** TRAINING CENTRES  
IN 15 COUNTRIES 

 **11,235**  
EMPLOYEES  
ALL OVER THE WORLD



**50** WATERPROOFING  
**12** SMOKE EXTRACTION  
**2** GEOTEXTILE  
**12** RECYCLING  
**41** INSULATION  
**7** METAL FRAME WORKSHOPS  
**2** SEALANTS & GLUES  
**2** GLUED LAMINATED WOOD STRUCTURES  
**79** CONTRACTING AGENCIES & SUBSIDIARIES

  
**128**  
PRODUCTION SITES

**23** RESEARCH & DEVELOPMENT CENTRES  
**270** MAINTAINED PATENTS  

# Reinforced membranes: The preferred choice for pool waterproofing

Reinforced membranes have become the top choice for architects, builders, and pool installers worldwide. Their versatility, durability, and ease of installation make them an ideal solution for waterproofing swimming pools across a wide range of applications, from private homes to public facilities and large-scale water parks.

## Why reinforced membranes outperform traditional systems

When selecting a pool waterproofing solution, reinforced membranes stand out by offering superior performance compared to traditional concrete pools finished with ceramic tiles or paint, as well as other systems like fiberglass.

→ **Complete waterproofing:** Unlike concrete pools finished with ceramic tiles, which rely on mortar joints prone to cracking, or concrete pools with painted surfaces that require additional waterproof coatings and frequent maintenance, reinforced membranes provide a seamless and fully watertight layer, completely eliminating the risk of leaks.

→ **Adaptability to all shapes and sizes:** Reinforced membranes easily conform to pools of all shapes and sizes, including complex or irregular designs such as curves, corners, and custom features. In contrast, fiberglass pools are limited to pre-molded shapes, and tiled concrete pools require meticulous cutting and alignment, making installation more complex.

→ **Time and cost efficiency:** Membranes are installed faster than tiled concrete pools, which require meticulous placement and grouting, as well as painted concrete pools, which often need multiple layers of waterproof coatings and drying time. This reduces labor costs and overall project timelines, making reinforced membranes a highly efficient solution.

→ **Superior resistance to external factors:** Concrete pools finished with tiles are vulnerable to frost damage due to the expansion and contraction of grout and tiles, while painted concrete pools can suffer from cracking and surface degradation over time. Reinforced membranes maintain their integrity, resisting cracks, UV rays, and chemical exposure for long-lasting performance.



→ **Low maintenance:** With their lacquered surface, reinforced membranes resist dirt, limescale, and algae growth. In contrast, tiled concrete pools require frequent grout cleaning and periodic regrouting to prevent water infiltration and staining, while painted concrete pools often need resurfacing or recoating to maintain their appearance and waterproofing properties.

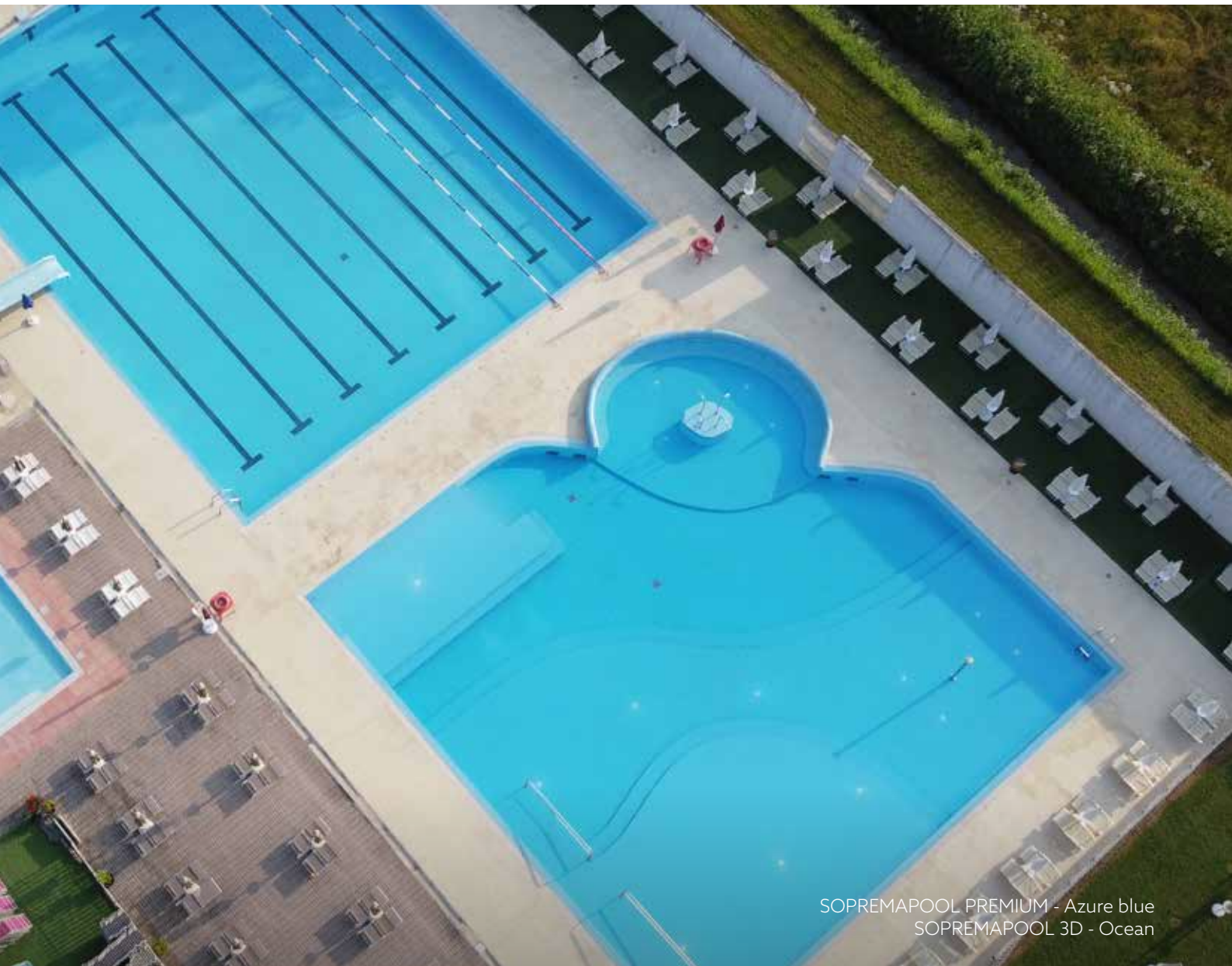

SOPREMAPOOL PREMIUM - Azure blue  
 SOPREMAPOOL 3D - Ocean

# Installation and renovation time comparison

Comparison of the time required to install each type of pool finish on a 10 x 5 m pool.

*\*These estimates are **approximate** and are based solely on the application of the **waterproofing finish**, excluding the time required for the construction of the pool structure itself.*

Process	New construction time*	Renovation time*
Reinforced membrane	2-3 days (including surface preparation and welding)	2-3 days (including surface preparation and welding)
Ceramic tiles	12-14 days (including waterproofing structure, tile placement, grouting, and drying)	5-7 days (grout repair, replacing broken tiles, and drying)
Paint coating	3-6 days (including waterproofing structure, surface preparation, multiple coats, and drying time)	3-6 days (including waterproofing structure, surface preparation, multiple coats, and drying time)

## New constructions and renovations

Reinforced membranes are the ideal solution for both new pool constructions and renovations. Their versatility makes them an excellent choice for modern projects, providing superior waterproofing, durability, and aesthetic flexibility. In new constructions, they ensure fast and reliable installation, while in renovations, they offer a seamless way to upgrade existing pools without the need for extensive work. This makes them particularly valuable for retrofitting pools with older waterproofing systems or damaged surfaces.

Key advantages for both new constructions and renovations include:

- **Fast installation:** Simplifies and accelerates the building process.
- **Seamless integration:** Perfect for upgrading old pools, eliminating the need for complex removal.
- **Durability:** Provides long-lasting protection, even in the most demanding environments.
- **Aesthetic flexibility:** Available in various colours and finishes to match design specifications.

## Applications for all pool types

Reinforced membranes are suitable for a wide variety of pool applications, including private pools, public pools, water parks, and both indoor and outdoor pools. Whether it's a luxurious private pool, a high-traffic public facility, an adventurous water park, or a stylish hotel pool, membranes offer the ideal balance of performance, aesthetics, and ease of maintenance.

- **Municipal pools and olympic pools, hotels and resorts, water parks, campsites, and sports centres:** High resistance to wear, easy maintenance, and the ability to withstand intensive use and adverse conditions, making it ideal for public installations.
- **Private Pools:** Perfect for homeowners seeking long-term durability, low maintenance, and a beautiful finish. Suitable for pools of all sizes, from small patio pools to larger backyard installations.
- **Indoor Pools:** Waterproofing and aesthetics that thrive in controlled environments with high humidity.
- **Outdoor Pools:** Perfect for pools exposed to the elements, offering UV resistance and durability in all weather conditions.

**Reinforced membranes meet the specific needs of each pool type**, ensuring that they maintain their integrity and appearance for years to come, regardless of location or usage.

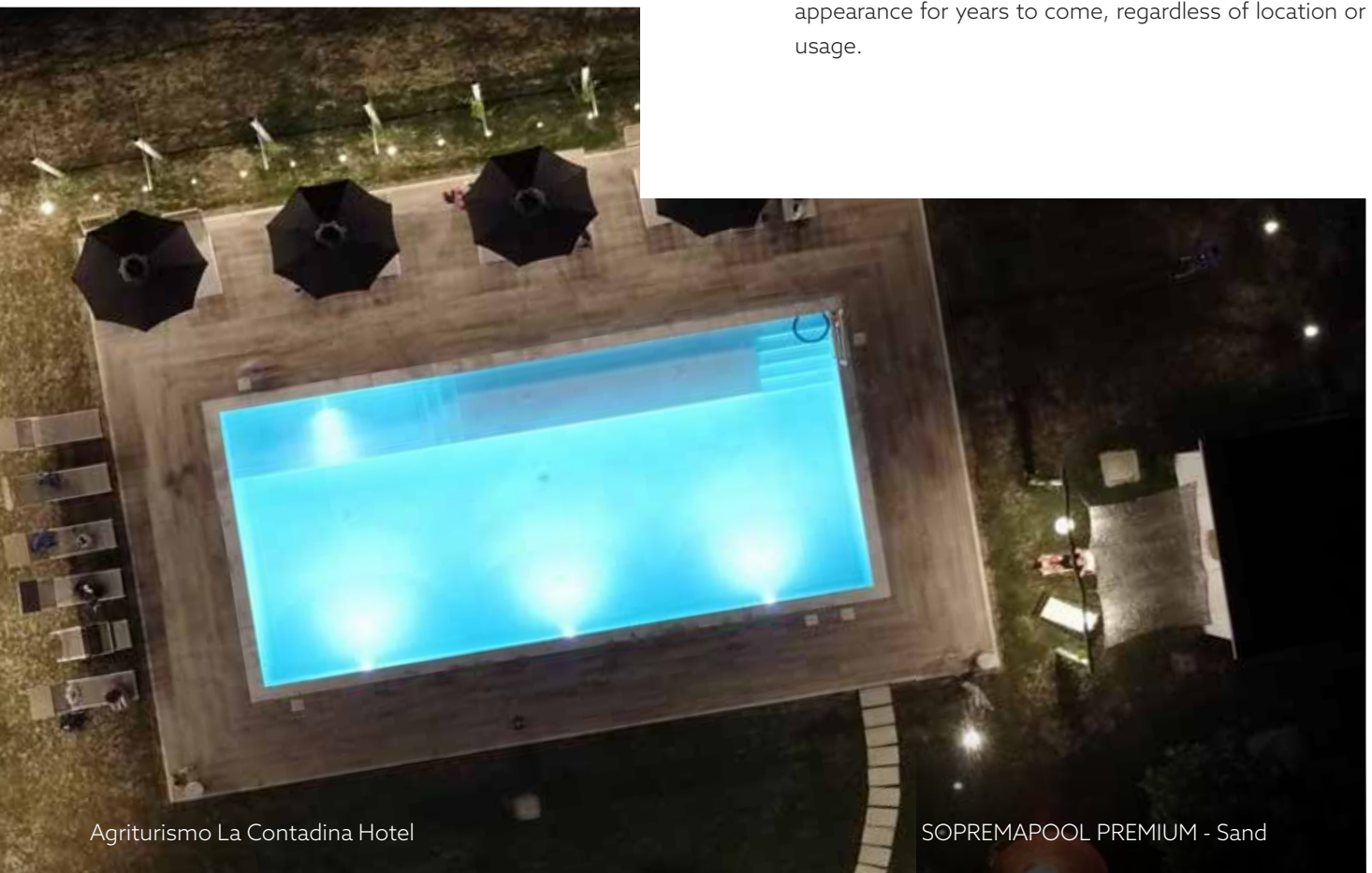

Agriturismo La Contadina Hotel

SOPREMAPOOL PREMIUM - Sand



Terme di Giunone

SOPREMAPOOL PREMIUM - Light blue



# SOPREMAPOOL ranges



SOPREMAPOOL PREMIUM - Azure Blue  
SOPREMAPOOL FEELING - Azure Blue

# SOPREMAPOOL

SOPREMAPOOL is a complete waterproofing system for swimming pools, consisting of reinforced membranes and technical installation solutions. It is designed to provide watertightness, durability, and low maintenance even under intensive use conditions.

A versatile, reliable, and aesthetic solution—ideal for all types of projects: from sports facilities and municipal pools to hotel complexes, recreational spaces, and private-use pools.

## 4-layer reinforced membranes

Reinforced synthetic membranes manufactured by cast process, using high-quality raw materials including resins, plasticisers, stabilisers, and pigments.

These membranes are composed of four layers with distinct, complementary formulations, incorporating a polyester reinforcement between the second and third layers. This reinforcement enhances the membrane's tensile strength and dimensional stability.

The formulation and production process are specifically designed to meet the rigorous performance standards outlined in the European EN 15836-2:2010 standard.

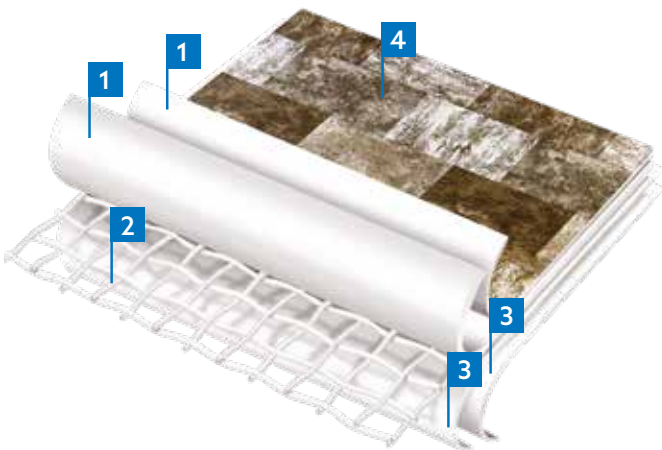

- 1 **High performance pvc:**  
Layers 1 & 2
- 2 **Polyester reinforcement**
- 3 **High performance pvc:**  
Layers 3 & 4
- 4 **Lacquer finish**

## Product advantages

- + **Optimal welding:** The advanced welding technology used in SOPREMAPOOL membranes ensures perfect seam integrity, preventing any water leakage and enhancing the overall durability of the installation.
- + **UV resistance:** Designed to withstand harsh UV exposure, SOPREMAPOOL membranes retain their colour and structural integrity over time, making them ideal for both outdoor and indoor pools.
- + **Resistance against microorganisms with "Bio Shield" treatment:** The "Bio Shield" treatment ensures long-lasting protection against algae, bacteria, and other microorganisms, preventing molecular changes and guaranteeing a cleaner, more hygienic pool environment.
- + **Impact resistance:** SOPREMAPOOL membranes are built to endure physical impacts, making them resistant to punctures and tears, which can be a common issue with traditional liners.
- + **High mechanical resistance:** The layers of the membrane are engineered for high tensile strength, ensuring that it can handle the demands of regular pool usage without compromising on performance.
- + **Chemical resistance:** Resistance to the standard chemicals used for pool water treatment, including chlorine, bromine, and salt, ensures they maintain their performance even in chemically challenging environments.

**SOPREMAPOOL**  
FEELING PLUS + PREMIUM  
+ DESIGN + 3D

WARRANTY*
<b>12</b> years Waterproofing

WARRANTY*
<b>3</b> years Stains**

\*It is essential to keep the product label for warranty issuance. \*\* Stains caused by bacteria.

# Ranges

Four lines of reinforced membranes designed to meet different levels of technical and aesthetic requirements, from public and sports pools to recreational and hotel settings.

Range	FEEELING PLUS	PREMIUM	DESIGN	3D
Application	Public and recreational pools, sports centers	Public and recreational pools, sports centers	Hotels, campsites, and design	Hotels, campsites, and design
Thickness	1.5 mm	1.5 mm	1.5 mm	1.8 mm
Varnish coating	Yes	Yes	Yes	Yes
Finish	Textured	Smooth	Printed smooth	Textured design
Anti-slip*	Yes	Grip**	Grip**	Yes
Warranty	12 years waterproofing + 3 years stain resistance***	12 years waterproofing + 3 years stain resistance***	12 years waterproofing + 3 years stain resistance***	12 years waterproofing + 3 years stain resistance***
Roll dimensions	1.65 x 25 m	1.65 x 25 m	1.65 x 25 m	1.65 x 25 m

\* Slip resistance according to European Standard EN 13451-1 (Annex B of EN 15836-2) and DIN 51097 (1992). Certified slip resistance Class C.

\*\* 1.5 mm non-slip reinforced membrane with embossed finish for pool areas with slip hazards, such as stair treads or shallow zones ( $\leq 1.5$  m).

\*\*\* Stains caused by bacteria.



# SOPREMAPOOL FEELING PLUS

NEW

1.5 mm reinforced membrane with a textured, non-slip, and varnished surface, specially designed for public pools, collective pools, and high-traffic sports centers.



SAND  
237460/SA



LIGHT BLUE  
237460/CA



AZURE BLUE  
237460/AB



WHITE  
237460/HB



MEDIUM GREY  
237460/GM



BASALT GREY  
237460/GA



Alma Hotel Barcelona

SOPREMAPOOL FEELING - Sand

# SOPREMAPOOL PREMIUM

1.5 mm reinforced membrane with a smooth, varnished finish, designed for intensive-use recreational facilities.



LIGHT BLUE  
156967/CA



AZURE BLUE  
156967/AB



SAND  
156967/SA



WHITE  
156967/HB



LIGHT GREY  
156967/GC



MEDIUM GREY  
156967/GM

## SOPREMAPOOL GRIP

(non-slip version)

1.5 mm reinforced membrane with embossed finish for pool areas with slip hazards, such as stair treads or shallow zones ( $\leq 1.5$  m).



Wave pool at Gino Paradise Water Park

SOPREMAPOOL PREMIUM - Azure blue  
SOPREMAPOOL FEELING - Azure blue

# SOPREMAPOOL DESIGN

1.5 mm reinforced membrane with a varnished finish and printed designs inspired by minerals, ceramics, mosaics, and marbles. The ideal choice for hotels, campsites, and spaces where aesthetics are key. Marbella Blue is available in a non-slip version (GRIP).

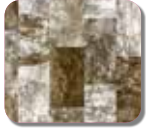

**MINERAL AMBER**  
156975/MNAM



**MINERAL SAPPHIRE**  
156975/MNBS



**MINERAL JADE**  
156975/MNJD

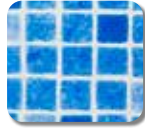

**MARBELLA BLUE**  
156975/MMB



**MARBELLA GREY**  
156975/MMG



**MOSAIC BLUE**  
156975/MNB



**SKY BLUE**  
156975/SB

## SOPREMAPOOL GRIP

(non-slip version)

1.5 mm reinforced membrane with embossed finish for pool areas with slip hazards, such as stair treads or shallow zones ( $\leq 1.5$  m).



Sports pool

SOPREMAPOOL DESIGN - Sky blue

# SOPREMAPOOL 3D

Exclusive 1.8 mm reinforced membrane with a non-slip relief and varnished finish.

Textured patterns that evoke minerals, ceramics, stone, or wood, providing resistance, safety, and distinction in high-value technical and visual projects.



**MINERAL AMBER**  
156988/MNAM



**MINERAL SAPPHIRE**  
156988/MNBS



**MINERAL JADE**  
156988/MNJD



**OCEAN**  
156988/SSOC



**SAHARA**  
156988/SSSH



**SENSITIVE WHITE**  
156988/SSHB



**ROCK**  
156988/SSRK



**BALI SAND**  
156988/SSBS



**WOOD**  
156988/SSWO



**WHITE WOOD**  
156988/SSWW



**INFINITE**  
156988/SSIN



Villa Imperiali

SOPREMAPOOL 3D - White wood

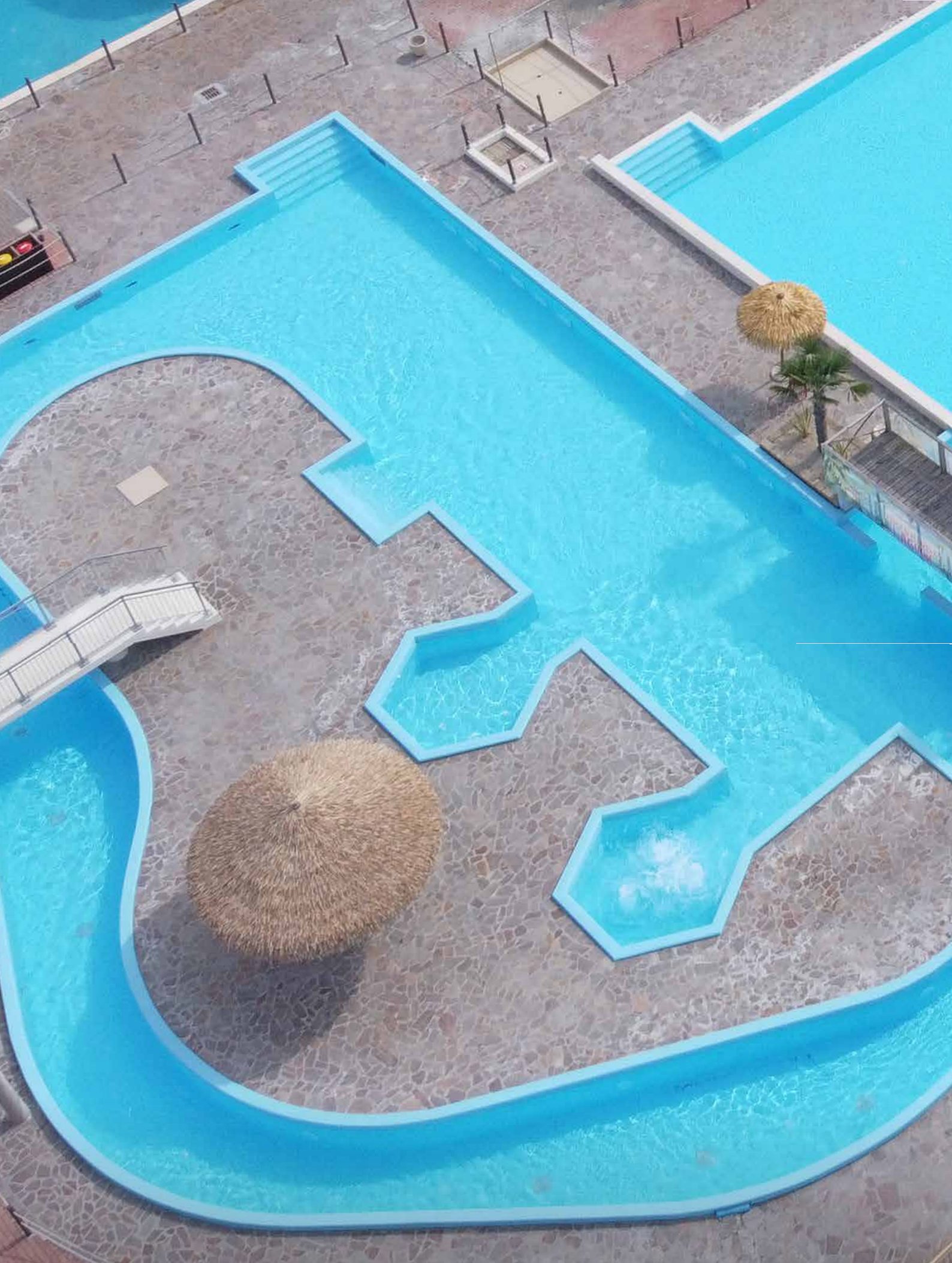

Acquasplash Franciacorta



# International projects

SOPREMAPOOL PREMIUM - Light Blue  
SOPREMAPOOL FEELING - Light Blue

# Macro Centro | Valenciana Aquatic Center

## Project description

This project involved the rehabilitation of two major aquatic structures: an Olympic Pool and a Diving Pit. The existing metal liner was replaced with SOPREMAPOOL Premium to address filtration issues and oxidation concerns.

The rehabilitation included detailed work with the membrane system to ensure long-term durability and performance in a high-use public facility.

**Location:** Guanajuato, Mexico

**Project type:** Rehabilitation of Olympic Pool and Diving Pit

**Surface area:** 2,595 m<sup>2</sup>

**Product:** SOPREMAPOOL Premium

**Installation company:** Albercas Dynamic SA de CV

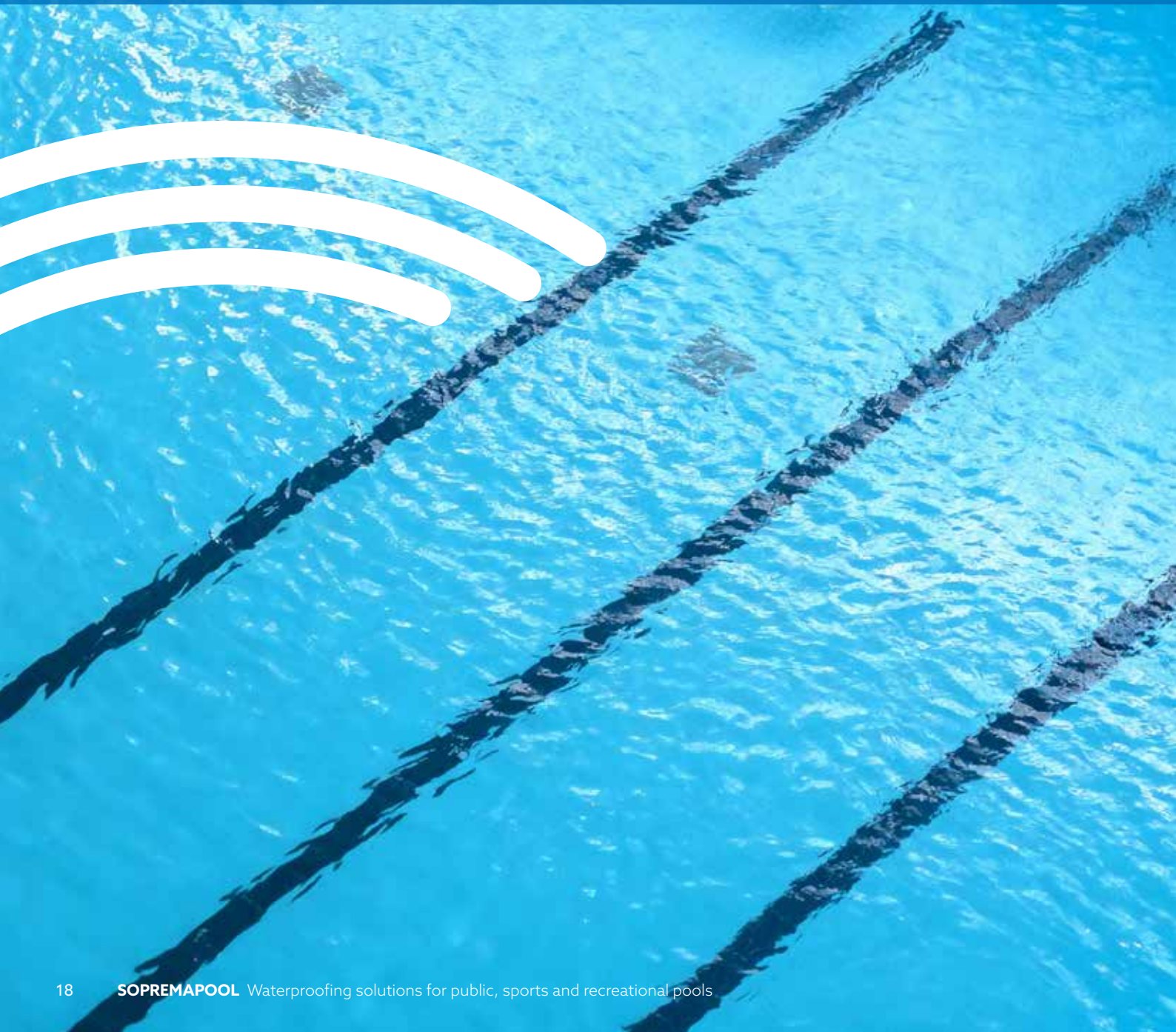

# Technical challenges & SOPREMA solutions

## → Challenge

**Filtration and oxidation problems:** The existing metal liner showed signs of oxidation, causing inefficiencies in filtration.

**Thermofusion in diving pit:** The diving pit, with a height of 5 meters, presented a significant challenge due to its height and complex structure.

**Long membrane seams:** The Olympic pool required a seamless integration of 50-meter-long lines.

## → SOPREMA solutions

SOPREMAPOOL Premium's superior waterproofing and resistance to mechanical stress resolved these issues, extending the lifespan of the pool.

The use of SOPREMAPOOL's high-performance membrane, combined with appropriate thermofusion equipment, ensured secure waterproofing.

The large membrane allowed for easy handling, reducing seams and providing a clean aesthetic result.

## Results & benefits



The new membrane system addressed the filtration problems by providing a highly effective waterproofing solution.



The membrane adapted perfectly to the metal panel system, with excellent thermal reaction and behavior, ensuring a precise and secure installation.



The membrane enhanced the overall aesthetic of the pool area, ensuring a visually appealing, safe, and easy-to-maintain environment.



SOPREMAPOOL Premium provides exceptional long-term durability. Its resistance to mechanical stress and weathering guarantees that the pool will maintain its integrity and appearance for years, reducing the need for frequent maintenance.

# Acquasplash Franciacorta Aquatic Park

## Project description

The refurbishment of the Acquasplash Franciacorta Aquatic Park involved updating two key recreational water areas: a Lazy River and a Slide Pool. The goal was to create a more attractive and durable environment, suitable for high-traffic use while ensuring safe and enjoyable experiences for visitors.

The project utilized SOPREMAPOOL Premium and SOPREMAPOOL Feeling membranes to address both aesthetic needs and the technical challenges of the park's environment.

**Location:** Corte Franca, Italy

**Project type:** Refurbishment of Lazy River and Slide Pool

**Surface area:** 1,855 m<sup>2</sup>

**Product:** SOPREMAPOOL Premium Light Blue and Feeling Light Blue

**Installation company:** Mafeco S.R.L.

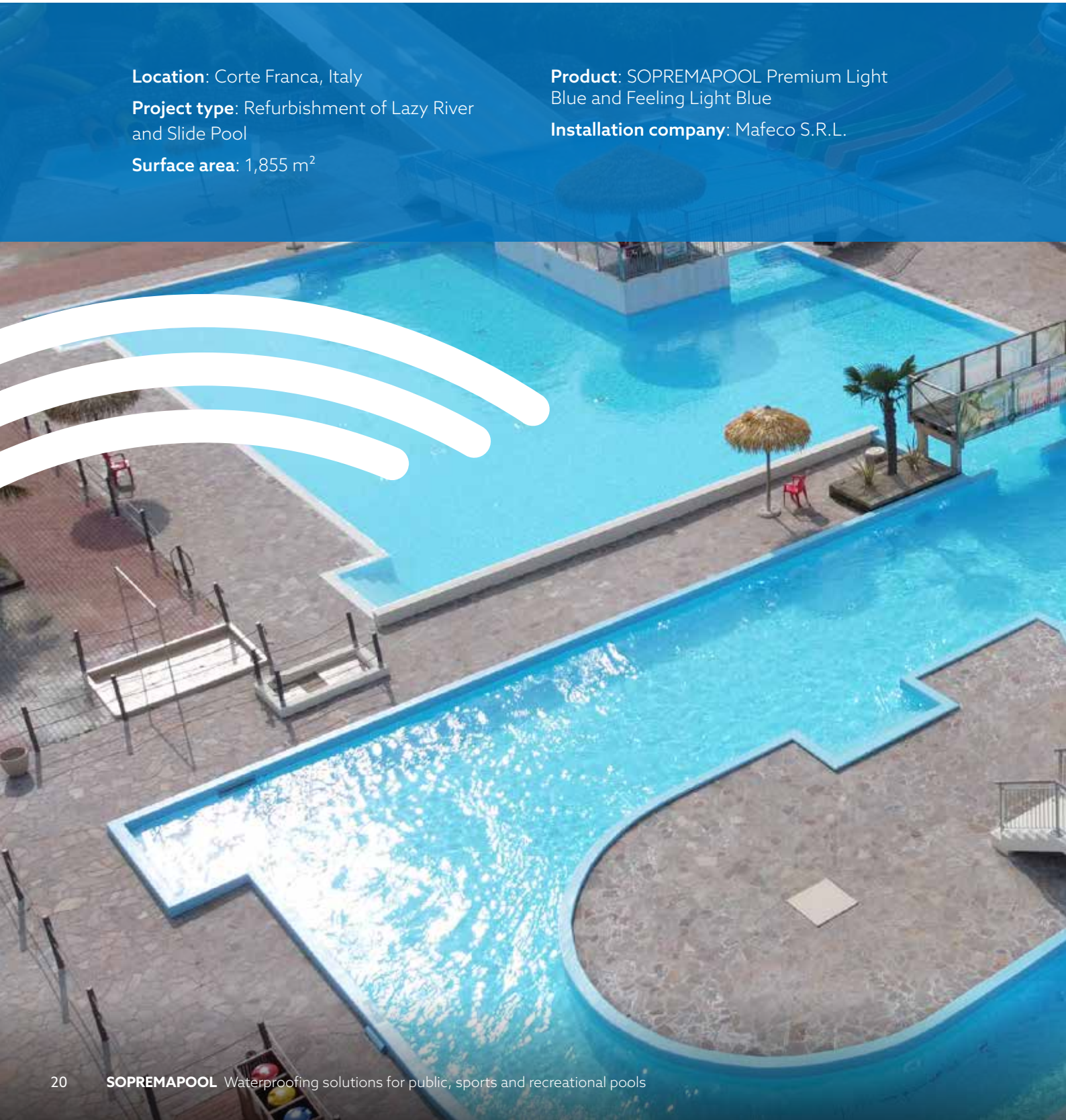

# Technical challenges & SOPREMA solutions

## → Challenge

**High-traffic zones:** The pool areas that experience heavy traffic, such as entry and exit zones, required extra protection against wear and tear.

**High humidity conditions:** The aquatic areas are continuously exposed to moisture, which can degrade standard materials over time.

**Aesthetic and functional finish:** The project required a membrane that offered both aesthetic appeal and long-term performance.

## → SOPREMA solutions

The SOPREMAPOOL Feeling membrane, with its durable and non-slip surface, was ideal for these high-traffic areas, providing safety and durability.

SOPREMAPOOL membranes' ability to withstand humid and high-temperature environments made it the perfect choice to maintain the integrity of the system.

The light blue tones of SOPREMAPOOL Premium and Feeling provided a visually attractive finish while ensuring the necessary durability and waterproofing.

## Results & benefits



The new membranes significantly reduced the need for ongoing maintenance, ensuring a long-lasting solution.



The modern design and light blue hues elevated the visual appeal of the pool area, aligning with the park's aesthetic goals.



The non-slip properties of the SOPREMAPOOL Feeling membrane improved safety for users across all aquatic zones.



The choice of SOPREMAPOOL membranes contributed to a more sustainable aquatic environment with minimal maintenance needs.

# Gino Paradise Aquapark

## Project description

The rehabilitation of the Wavy Pool and Wild River at Gino Paradise Aquapark involved several technical complexities that required the direct involvement of the SOPREMA technical department. The Wavy Pool, which generates waves using air pressure blowers, is exposed to dynamic water movement and high mechanical stress, complicating membrane anchoring.

In addition, the Wild River required unique solutions due to its continuous exposure to water and high foot traffic. SOPREMA's team designed a customized solution for both pools, ensuring both waterproofing and aesthetic integration with the park's theme.

**Location:** Tbilisi, Georgia

**Project type:** Refurbishment of Wavy Pool and Wild River

**Surface area:** 3,834 m<sup>2</sup>

**Product:** SOPREMAPOOL Premium Azure Blue and Feeling Azure Blue

**Installation company:** GLS Techno LTD

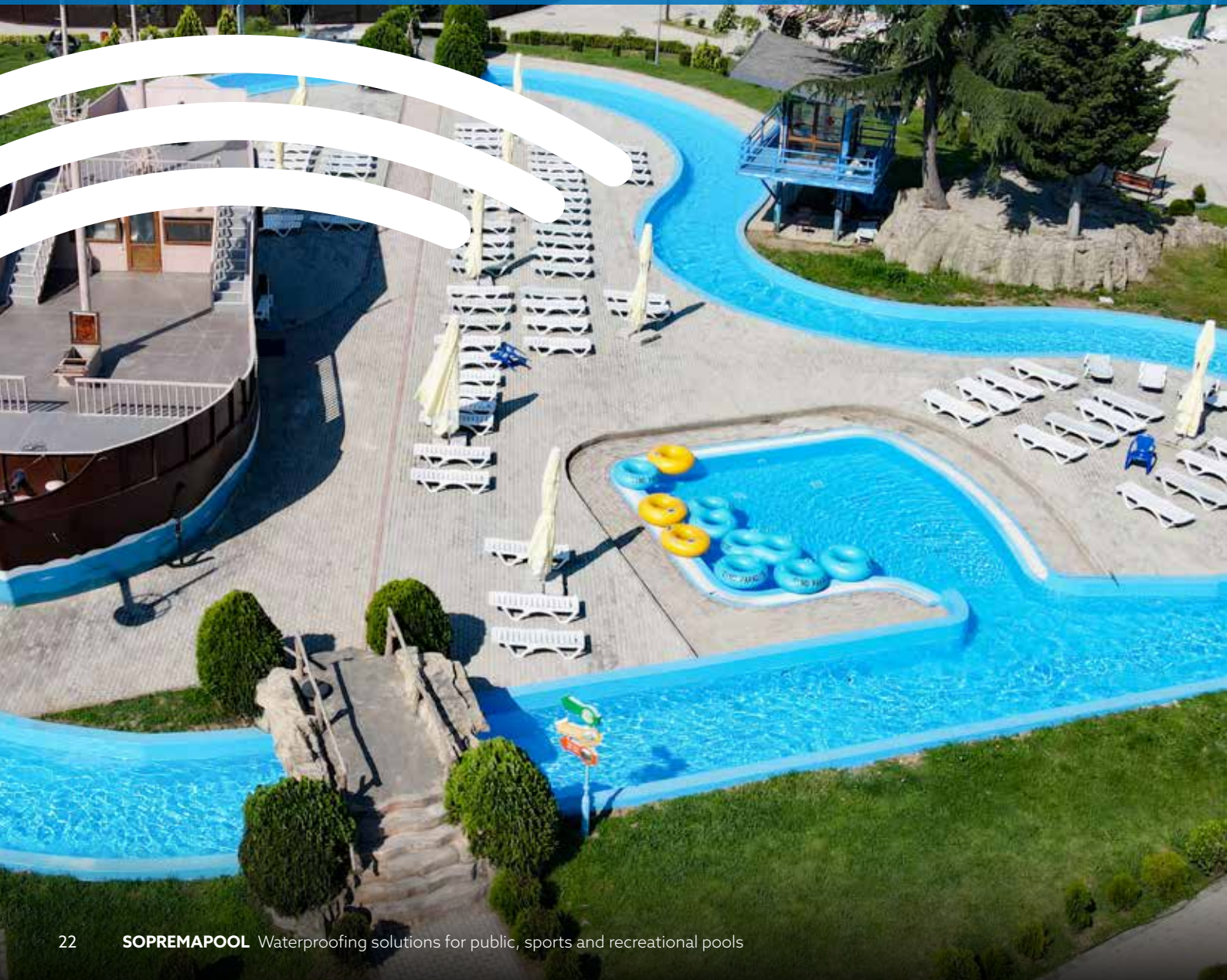

# Technical challenges & SOPREMA solutions

## → Challenge

**Wave-generation area (Wavy Pool):** The zones surrounding the air pressure blowers, essential for wave creation, were highly exposed to dynamic water movement and high mechanical stress. These conditions made membrane anchoring especially complex.

**Vertical climbing wall waterproofing:** This wall, located directly above the Wavy Pool, presented one of the most critical challenges due to its vertical geometry and permanent exposure to water and physical contact.

**Anti-slip surfaces in shallow/beach areas:** To ensure user safety in areas less than 1.5 m deep and in beach-like entries, SOPREMAPOOL Feeling membranes were used.

**Substrate preparation and microbial protection:** The existing pool surfaces required protection to prevent abrasion, microbial growth, and premature wear of the new membrane.

## → SOPREMA solutions

Our team designed a custom mechanical fixing system using metal PVC angles and flat profiles to ensure a robust, watertight solution capable of withstanding pressure fluctuations and vibration.

SOPREMA developed a special installation protocol for vertical membrane application, combining mechanical fastening and watertight welding techniques to guarantee durability and safety.

These membranes comply with EN 13451-1 and DIN 51097 (1992) for slip resistance, making them ideal for high-traffic aquatic zones.

A continuous layer of Geoland HT 300 geotextile was installed across all areas as a separation and protective layer between the substrate and the waterproofing membrane. This provided added durability, cushioning and microbial resistance, helping to preserve the integrity of the membrane and prolong the system's lifespan.

## Results & benefits



Significant reduction in maintenance needs, replacing frequent repainting with durable waterproofing.



Enhanced aesthetics and technical performance.



Increased safety and compliance in high-traffic wet zones.



Microbial growth prevention, enhancing the durability of the membrane and extending its lifespan.

# Hilton Double Tree

## Project description

The project involved the refurbishment of the terrace pool at the Hilton Double Tree, a heritage hotel. The goal was to perform a quick and effective repair of the existing tiled pool system, using the SOPREMAPOOL Design Mosaic Blue membrane to ensure a reliable and durable waterproofing solution.

This approach allowed the hotel to continue its operations with minimal disturbance to guests. The project was completed without dismantling the existing tile or waterproofing system, significantly reducing costs and time.

**Location:** Jaipur, India

**Project type:** Refurbishment of terrace pool

**Surface area:** 300 m<sup>2</sup>

**Product:** SOPREMAPOOL Design Mosaic Blue

**Installation company:** Dreamz Pools India



# Technical challenges & SOPREMA solutions

## → Challenge

### **Quick refurbishment with minimal disruption:**

The hotel required a speedy solution to refurbish the pool without interrupting hotel operations or guest experience.

**Design consistency:** The design of the membrane needed to blend seamlessly with the existing pool tiles.

**Waterproofing integrity:** Ensuring the pool would be leak-proof and operate safely for guests was paramount.

**PVC strip for termination without removal of coping stone:** To minimize disruption and reduce labor costs, the installation utilized a PVC strip for the termination of the membrane.

## → SOPREMA solutions

SOPREMAPOOL membrane was applied directly over the existing tile system, with no need for dismantling, ensuring a quick turnaround without affecting the hotel's services.

The SOPREMAPOOL Design Marbella Blue was selected for its aesthetic compatibility with the existing design, providing a visually cohesive and elegant finish.

The 1.5 mm Marbella Blue membrane, along with the 900 GSM geotextile, provided a reliable waterproofing solution that eliminated the risk of leaks, ensuring the pool was safe and secure.

This solution allowed the membrane to be securely terminated without the need to remove the existing coping stone, maintaining the structural integrity and aesthetic finish of the pool while speeding up the installation process.

## Results & benefits



The project was completed in just 7 days, minimizing disruption to hotel operations and ensuring the pool was ready for use in a short time frame.



The SOPREMAPOOL membrane is designed for long-lasting performance, reducing the need for frequent maintenance and contributing to the hotel's sustainability efforts.



By avoiding the need to dismantle the existing tiles and waterproofing, the hotel saved time and money.



The design of the SOPREMAPOOL membrane matched the existing tile system, enhancing the pool's aesthetic appeal while ensuring a durable, leak-proof environment.

# | Hôtel Rive-Gauche – Refuge Gourmand

## Project description

The Hôtel Rive-Gauche – Refuge Gourmand underwent a refurbishment of its Pool and Spa Area, utilizing SOPREMAPOOL membranes to ensure superior waterproofing and aesthetic appeal. The project focused on upgrading the spa environment with a unique design combining functionality and visual appeal.

The installation included the use of SOPREMAPOOL 3D Rock and Sensitive White for an enhanced aesthetic finish while providing reliable waterproofing performance.

**Location:** Bel-Oeil, Québec, Canada

**Project type:** Refurbishment of Pool and Spa Area

**Surface area:** 93 m<sup>2</sup>

**Product:** SOPREMAPOOL 3D Rock and Sensitive White

**Installation company:** Destination Piscines Horizon

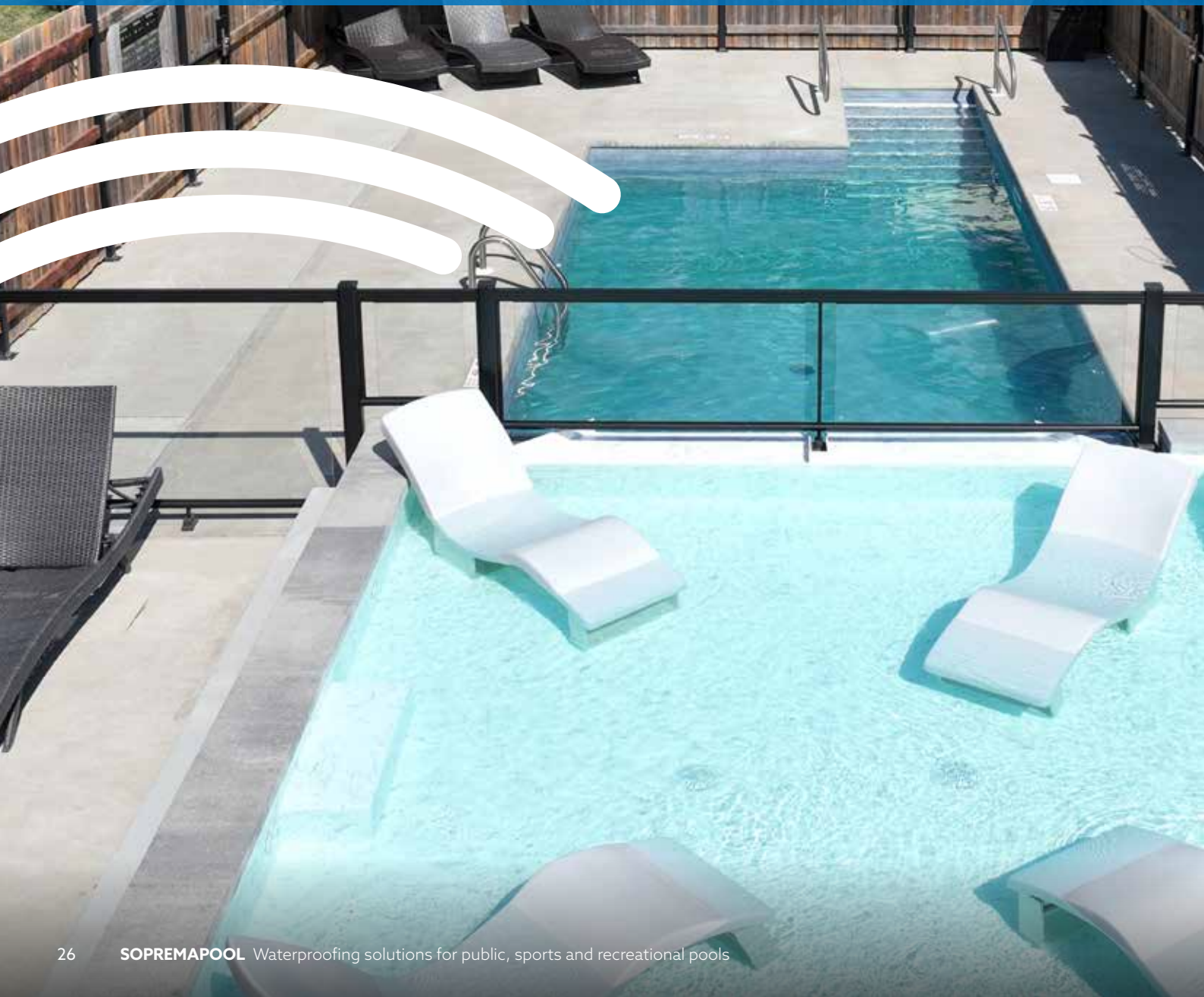

# Technical challenges & SOPREMA solutions

## → Challenge

**Pool and spa waterproofing:** The spa environment presents challenges due to constant moisture and temperature fluctuations.

**Aesthetic integration:** The hotel wanted a design that would blend seamlessly with the surrounding décor while offering durability and ease of maintenance.

**Quick installation:** The project required a fast turnaround to minimize disruption for the hotel's operations.

## → SOPREMA solutions

SOPREMAPOOL's 3D Rock and Sensitive White membranes provided the ideal solution, ensuring complete waterproofing while withstanding the spa's high humidity levels.

The SOPREMAPOOL 3D Rock, with its textured surface, offered a visually distinctive finish, while the Sensitive White membrane provided a sleek, clean look suitable for luxury spaces.

The flexibility and ease of installation of SOPREMAPOOL membranes allowed for the project to be completed within a two-week timeframe, meeting the hotel's requirements for a quick refurbishment.

## Results & benefits



The combination of SOPREMAPOOL 3D Rock and Sensitive White enhanced the visual quality of the pool and spa area, aligning with the hotel's luxury branding.



The non-slip properties of the 3D range surface enhanced the safety of the pool and spa areas, ensuring guest comfort and compliance with safety regulations.



The membranes ensured long-lasting protection against moisture and wear, reducing the risk of leaks and maintenance issues.



The project was completed efficiently within two weeks, minimizing downtime for the hotel and allowing them to reopen the spa quickly.

# Technical expertise at your service

## Our role begins long before the membrane is installed

From the initial design phase, we work closely with architects, consultants, installers and contractors to analyse technical challenges, interpret drawings and propose the most suitable solutions based on the project's scale, location, use and budget. This often includes:

- Assistance in selecting the ideal SOPREMAPOOL membrane type and finish.
- Adaptation to complex structures (overflow edges, beach entries, vertical walls, mechanical constraints).
- Creation of custom installation details for critical points.
- Advice on substrate preparation, drainage layers and compatible fixing systems.
- Calculation of quantities and optimised layout plans.
- Technical documentation and compliance guidance with European standards.

## Reliable systems with long-term guarantees

Our collaborative, project-specific approach ensures the correct application of each membrane and maximises its performance over time. This is also the key to maintaining the integrity of our long-term product warranties.

By working alongside our technical department, clients and installers benefit from greater precision, reduced risk of error, faster execution, and lasting results.

We turn challenges into opportunities for excellence.

For technical enquiries, please contact:

[sopremapool@soprema.com](mailto:sopremapool@soprema.com)

## Customised solutions for every challenge

Unexpected complexities can arise during the execution phase—such as structural irregularities, high-pressure zones, or non-standard geometries. These require more than a standard approach.

At SOPREMA, our technical department anticipates these challenges and provides well-prepared, project-specific solutions based on years of experience in aquatic facilities. We support installation teams with:

- Bespoke detailing for complex joints and critical zones.
- Clear installation protocols adapted to real site conditions.
- Reinforcement strategies for high-stress areas.
- Expert guidance to ensure system integrity and performance.

Tailored support for every project, from design to installation.



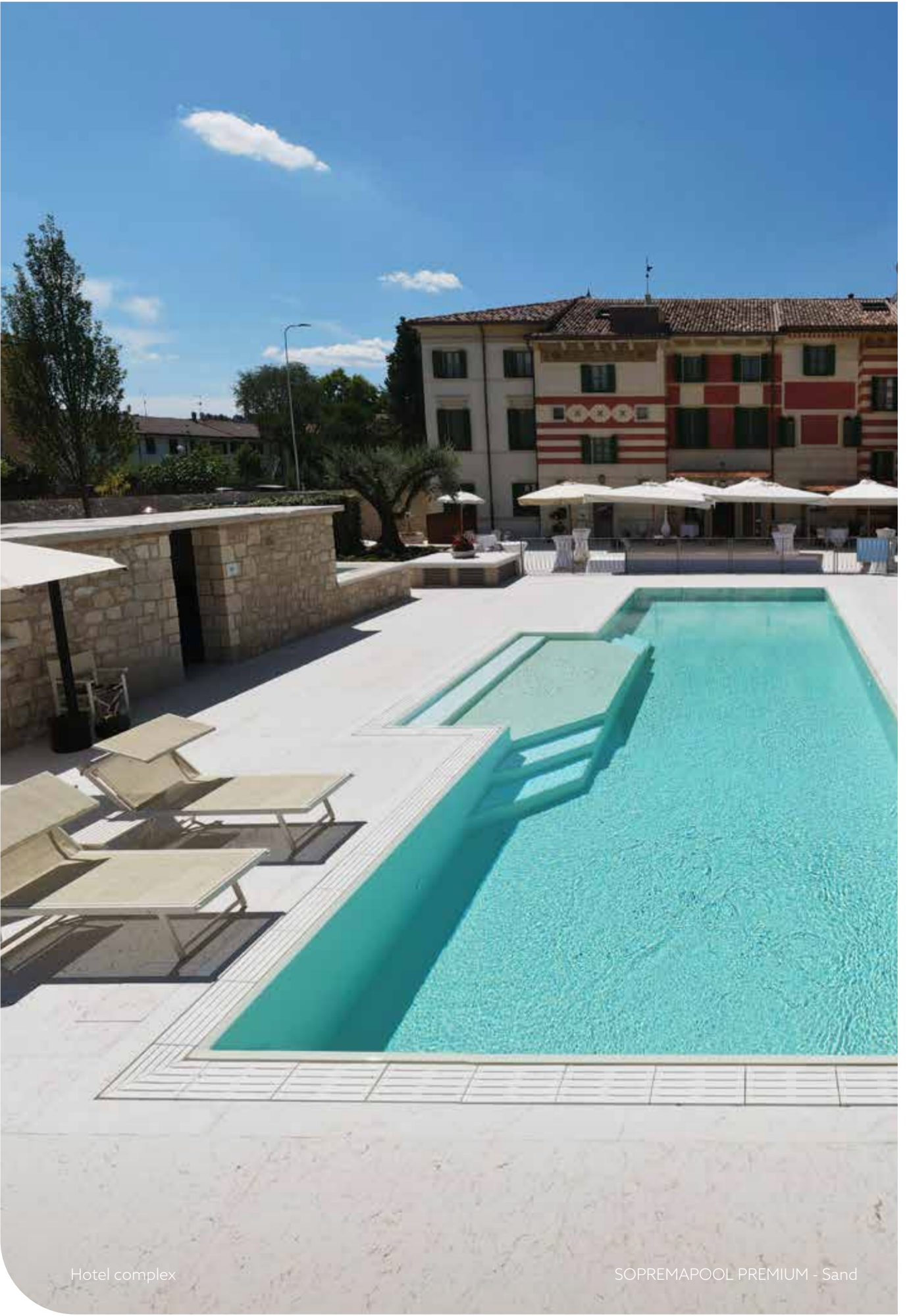

Hotel complex

SOPREMAPOOL PREMIUM - Sand

# Technical resources that support every project



## Environmental Product Declaration (EPD)

SOPREMA is committed to sustainability and environmental responsibility. Our **Environmental Product Declarations (EPD)** provide a transparent and credible source of information about the environmental impact of our membranes, ensuring that every product we offer is designed to meet sustainable building practices. The EPDs for SOPREMAPOOL membranes give detailed data on their environmental performance, supporting environmentally conscious decisions in your projects.

[Explore SOPREMA EPDs for accurate environmental impact data.](#)



## BIM objects for efficient design

Our **BIM (Building Information Modeling) objects** offer architects, engineers, and construction professionals a powerful tool for designing and specifying SOPREMAPOOL systems within digital building models. These objects streamline the design process, ensuring precise and easy integration of our waterproofing solutions into architectural plans.

[Download SOPREMAPOOL BIM objects for seamless integration into your project.](#)

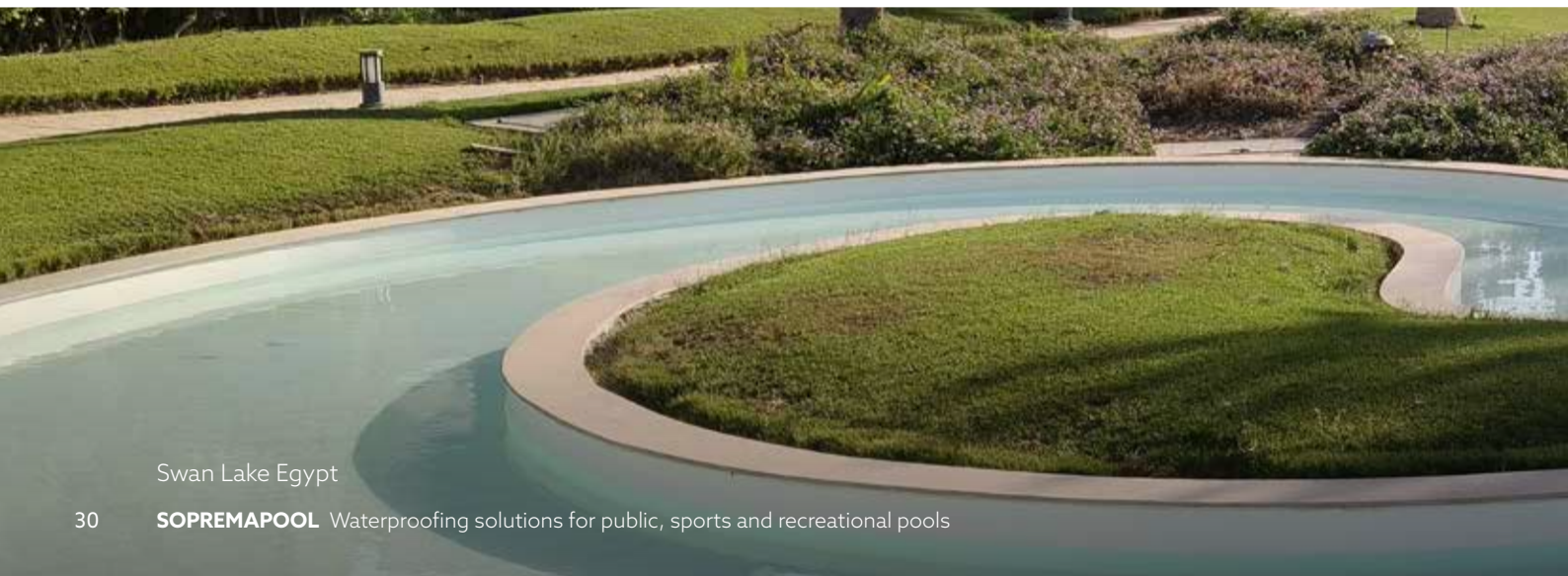



Discover each **SOPREMAPOOL** membrane immersed in water



**SOPREMAPOOL:**  
a complete system,  
a single provider

We complement our membranes with a set of technical solutions for a professional and long-lasting installation:

- Liquid PVC to improve the finish of welds
- Protective and separating geotextile
- Spray adhesives and contact glue
- Profiles, cords, plates, and rivets
- Welding strips and lane marking strips for swimming lanes

Discover everything SOPREMAPOOL can bring to your project.



**Installation training**

At SOPREMA, we offer specialized training for construction professionals, providing the technical knowledge required to ensure proper installation and optimal performance of the SOPREMAPOOL system.

Scan the QR code to request more information.





Since 1908, SOPREMA has been improving people's well-being and protecting their environment with innovative and sustainable waterproofing, insulation, soundproofing, and vegetated solutions for builders in the roofing, building envelope, civil engineering and swimming pool sectors.

## SOPREMAPOOL

**SOPREMA group at your service**

A dedicated team to answer your technical and commercial questions.

[sopremapool@soprema.com](mailto:sopremapool@soprema.com)



[sopremapool.com](http://sopremapool.com)



**Waterproofing**



**Insulation**



**Vegetative  
Solutions**



**Protection**



**Soundproofing**



**Solar**



**Water  
Management**